

Section 28 - Block 1

Heads to the South

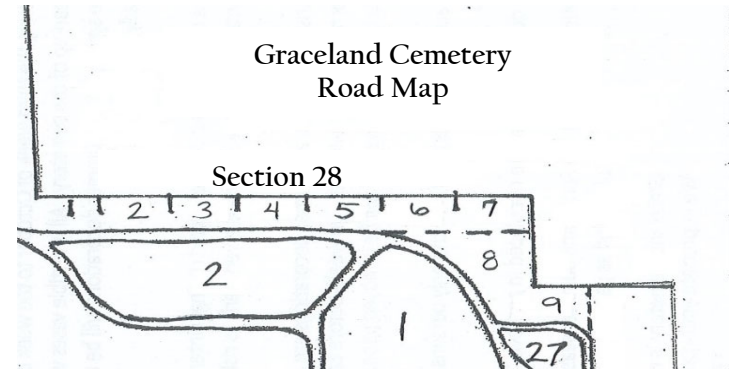
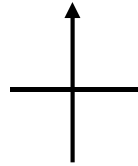

Pine Trees By Fence

	1	2	3	4	5	6	7	8	9	10	11	12	13	14	15	16	17	18	19	20	21	22	23	24	25	26	27
Row 4	Wilks							Joy					Boyd		Coleman			Payne						Smith			
Row 3				Beene			McMutry				Blount			Williams			McKinley						Thomas & Crawley		Myles-Knox		
Row 2	Byrd					Callier		Groves			Meeks			Cole				Greene	Greene		Evans			Thompson			
Row 1	Wilks			Taylor	Jakcsor			Turner				Lee		Francis			Ross		Fellow				Glover				

----- ROAD -----

Section 28 - Block 2

Heads to the South

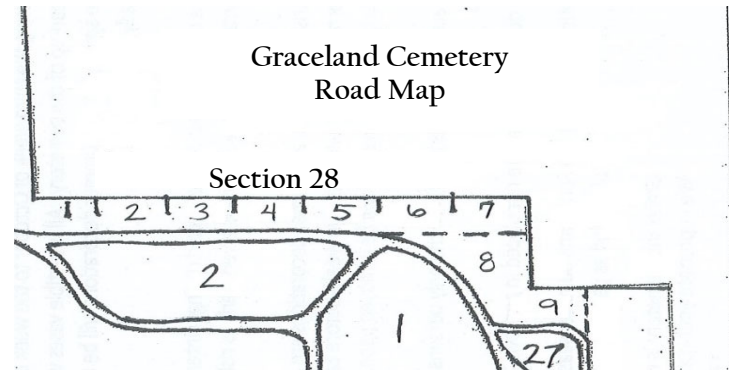
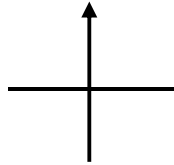

Pine Trees By Fence

	1	2	3	4	5	6	7	8	9	10	11	12	13	14	15	16	17	18	19	20	21	22	23	24	25	26	27
Row 4	Wright		Barfield					McThadde			Chaplin										Ford		McClinton	McClinton			Wilks
Row 3				Hall			Holifield				Harris	Harris													Smith		
Row 2			Semons	Lewis		Davis		Batchelor	Marable			Smith						Gant			Brown					Engl	
Row 1	Nichols			Nicholas					Hardin								Flowers	Thorns		Williams			Williams			Johnson	

----- ROAD -----

Section 28 - Block 3

Heads to the South

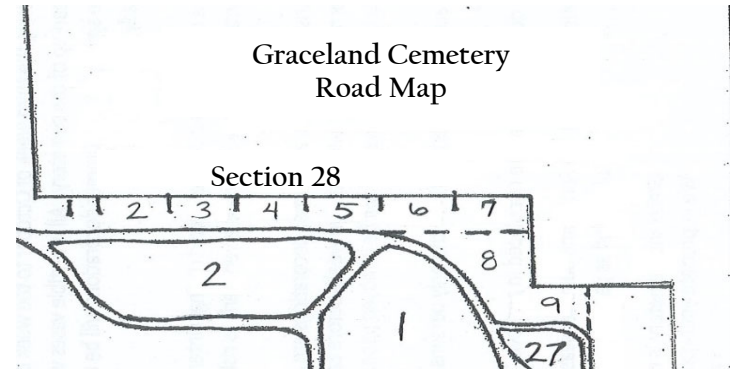
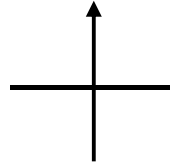

Pine Trees By Fence

	1	2	3	4	5	6	7	8	9	10	11	12	13	14	15	16	17	18	19	20	21	22	23	24	25	26	27
Row 4										Wallace								Harper				Dodd	Bannister				
Row 3		Hendrix						Bentley		Grimes					Williams							Kelly					
Row 2		Hoffman						McNeal		Gehl	Simmons			Wallace		Morehouse							Johnson	Scott	Scott		
Row 1	King		Green				Baldwin				Gee			Cowans	Matlock		Mack				Hale		Jackson		O'Neal	O'Neal	

----- ROAD -----

Section 28 - Block 4

Heads to the South

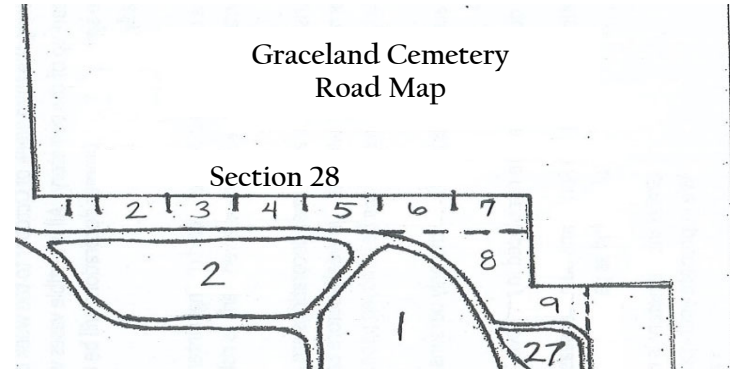
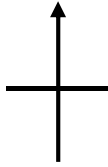

Pine Trees By Fence

	1	2	3	4	5	6	7	8	9	10	11	12	13	14	15	16	17	18	19	20	21	22	23	24	25	26	27
Row 4								Perry			Twitty		McGlowr				Gray					Coleman				Currie & Shanks	
Row 3	Bannister			Baker							Scott			Turner			Hill				Barksdale			Watson			
Row 2		Gray				Lynch	Taylor							Leeper							Hunter				Shanks		Washington
Row 1	Stribling			Edwards				Crawford				Robbins	Brown										Williams				Ward

----- ROAD -----

Section 28 - Block 5

Heads to the South

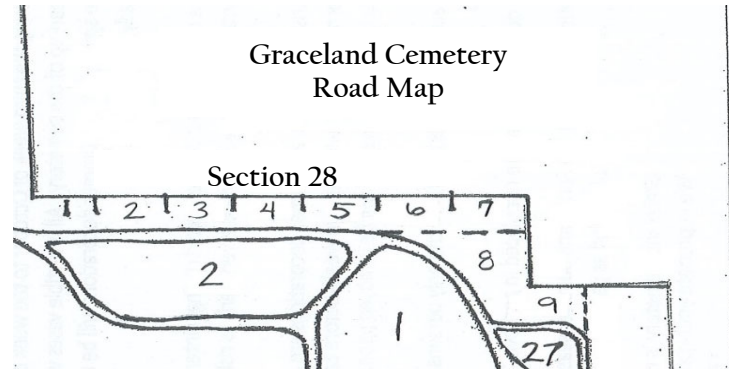
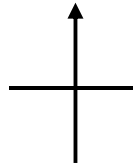

Pine Trees By Fence

	1	2	3	4	5	6	7	8	9	10	11	12	13	14	15	16	17	18	19	20	21	22	23	24	25	26	27	
Row 4							Grant	Grant	Grant									Morris		Brooks								
Row 3	Jones			Wholf						White-Brown		Alderson	Alderson	Alderson				Metcalf					Bell			Aikens		Dorsey
Row 2	Alderson			Bryant				Jacobs	Jacobs						Reed			Curry	Curry				Hall			Hawkins		
Row 1	Marrow		Warren		Stingley			Jacobs		Lewis					Jenius		Brantley	Brantley							Campbell		Malone	

----- ROAD -----

Section 28 - Block 6

Heads to the South

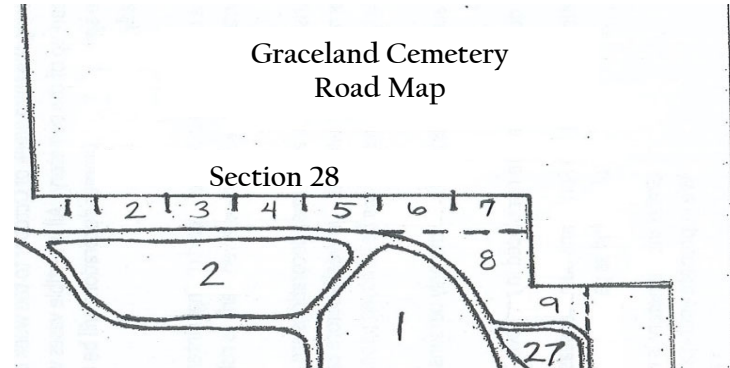
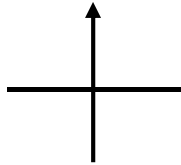

Pine Trees By Fence

	1	2	3	4	5	6	7	8	9	10	11	12	13	14	15	16	17	18	19	20	21	22	23	24	25	26	27
Row 4		Redwood	Jackson	Jackson		Gill		Anderson				Shaw		Shaw								Davis			Daniel		Thornton
Row 3	Watson					Tacke		Rand		Matthews					Shaw		McGee			Jacobs							Young
Row 2				Parker	Forest					Young		Moore		Triplett		Wright					Gray	Gray		Jackson			
Row 1	Lewis		Greer			Johnson						Ford					Greer					Johnson	Neal				Ashley

(BLOCK 7 Begins Here)

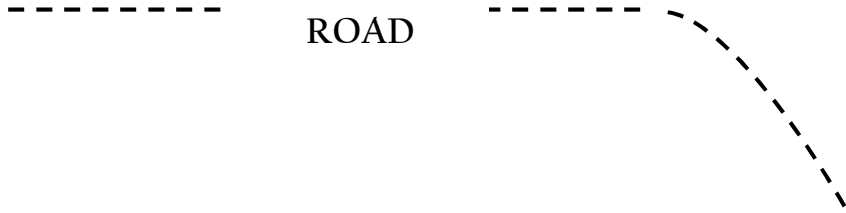

ROAD

(BLOCK 8 Begins Here)

Section 28 - Block 7

Heads to the South

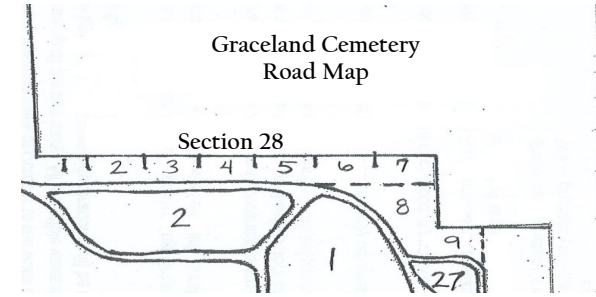
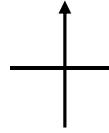

Pine Trees By Fence

	1	2	3	4	5	6	7	8	9	10	11	12	13	14	15	16	17	18	19	20	21	22	23	24	25	26	27	28	29	30	31	32	33	34	35	36	37	38	39	40	41	42	43				
Row 4	Bratchett			Vaughn				Laster			Bell		Saxton			Thomas					Pasha				Hill	Wose				Teague				Lewis													
Row 3	Johnson		Jones			Brown					Clark	Belton				Santiago						Yancey						Lewis			Hall						Buford					Reed					
Row 2			Vann	Vann			Hudson					Turner										Battle						Ezel	Cox				Jones			Haynes			Garrett							Sims	
Row 1	Saxton		Hughes		Hughes						Martin		Mosby			Mosby						Crump						Winters					Riley			Allen								Johnson			

..... Fence

(BLOCK 8 Begins Here)

